

KINGLIGHT

Ultraviolet Water System
a KINETICO brand

USER MANUAL - 7LPM

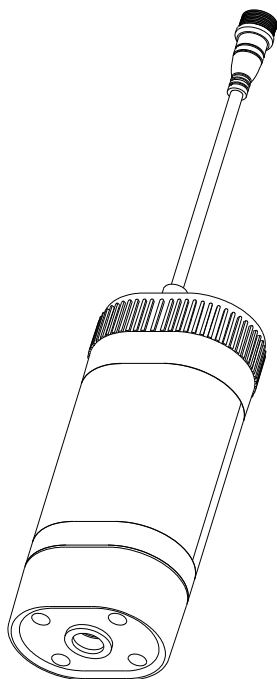

BACTERICIDAL
EQUIPMENT
UV LED



DOES NOT HEAT
WATER



3.000 HOURS
OF LIFE

APPLICATIONS

Filtration equipment
Reverse osmosis
Horeca
Laboratories
Restaurants
Domestic

01. PRODUCT DIAGRAM

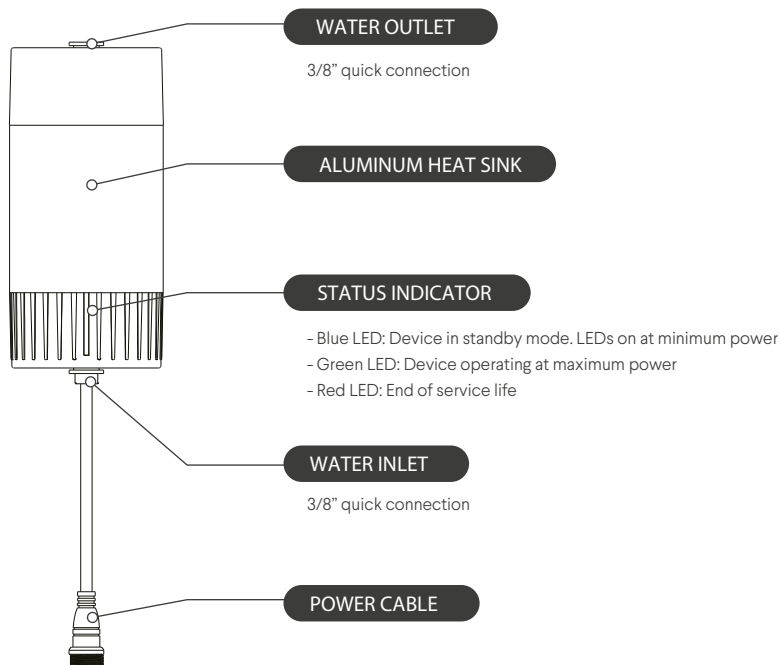

02. SAFETY WARNINGS

- Do not touch the metal heat sink if the device has been operating for a long time.
- Follow the correct water flow direction when installing the device.
- Use only the power supply provided with the device.
- Disconnect the device from the power supply before handling.
- Use the device within the specified pressure and temperature ranges.

03. PRODUCT DESCRIPTION

This UV sterilization device uses ultraviolet light to sterilize the water inside.

It effectively destroys the DNA structure of various viruses, bacteria, and other pathogens in the water, preventing their reproduction.

- Instant-on and sterilization
- Flow detector activation (minimum flow: 1 lpm)
- Long service life
- Mercury-free
- Energy saving

04. INSTALLATION AND OPERATING INSTRUCTIONS

1

Install the water inlet tube in the direction shown in the diagram and ensure it is properly connected.

Inlet pipe: 3/8"

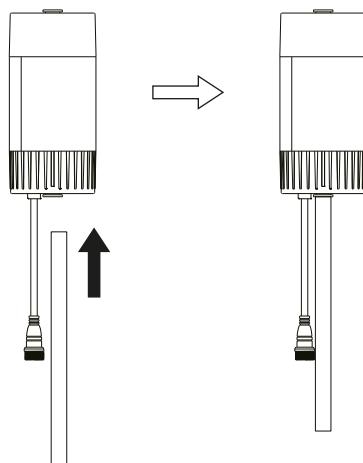

04. INSTALLATION AND OPERATING INSTRUCTIONS

- 2 Install the water outlet tube in the direction shown in the diagram and ensure it is properly connected.

Outlet pipe: 3/8"



Make sure to follow the water flow direction indicated on the device.

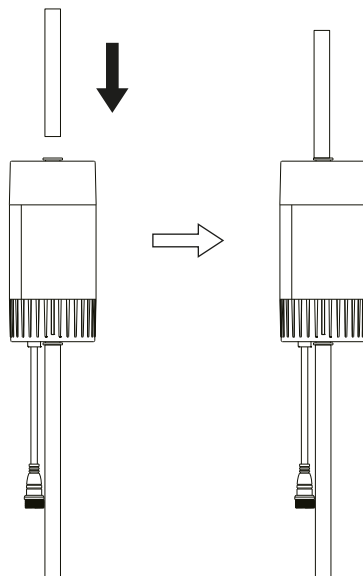

- 3 Connect the device's power supply.
- 4 Plug the power supply into an electrical outlet. The indicator light will turn blue.

STATUS INDICATOR

- Blue LED: Equipment in standby.
LEDs on at minimum power.

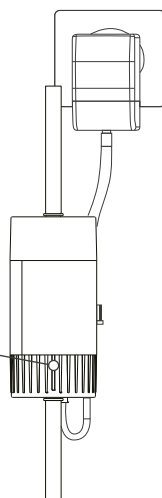

04. INSTALLATION AND OPERATING INSTRUCTIONS

5

When the device detects water flow, it will activate and the indicator will turn green. After 3000 hours of use, the indicator will turn red and the device will emit an acoustic signal.

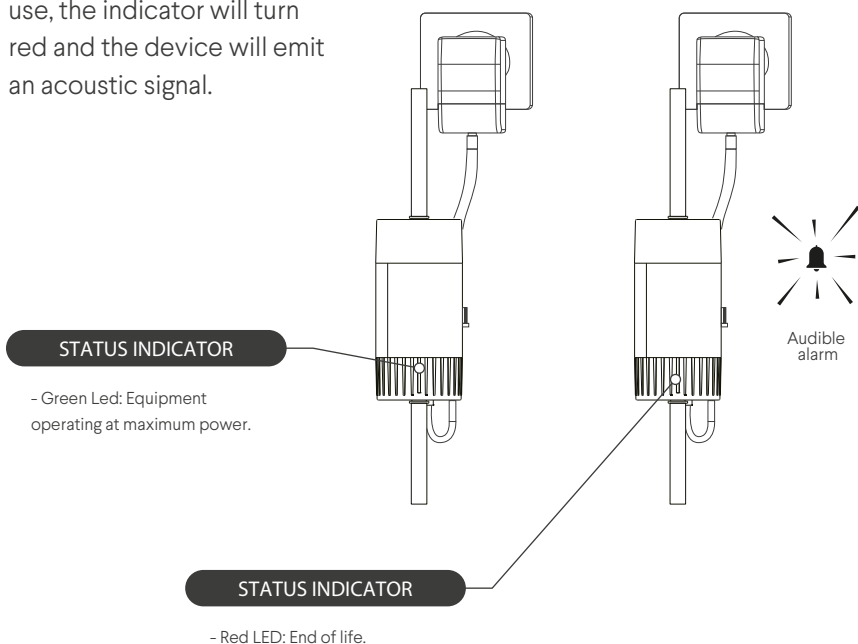

05. WARRANTY TERMS

The distributor guarantees the equipment for a period of three years against any lack of conformity that may be detected, in accordance with Royal Decree-law 7/2021 of April 27, implementing European Union directives in matters of competition, prevention of money laundering, credit institutions, telecommunications, tax measures, prevention and remediation of environmental damage, posting of workers in the provision of transnational services, and consumer protection.

The warranty covers the repair and replacement of defective parts by personnel authorized by the distributor or by the official technical support service (S.A.T.), either at the installation site or at their workshops. Labor and any shipping costs that may arise are included in the warranty.

The distributor is exempt from providing warranty coverage in cases of parts subject to natural wear and tear, lack of maintenance, impacts, or other non-conformities resulting from improper or inadequate use of the equipment, contrary to the conditions and operational limits specified by the manufacturer. Likewise, the warranty becomes void in cases of mishandling or misuse of the equipment, or if it has been modified or repaired by personnel not affiliated with the distributing company or the official technical service (S.A.T.).

Replaced parts under warranty shall become the property of the distributor.

The distributor is liable for any lack of conformity of the equipment related to the origin, identity, or suitability of the products, in accordance with their nature and intended purpose. Given the characteristics of the equipment, compliance with the technical conditions for installation and operation is essential for the warranty to cover any lack of conformity. Failure to meet these conditions may void the warranty, considering the importance of the equipment's intended use and the conditions and limits under which it must operate.

The distributor must ensure that the installed equipment is suitable for improving the quality of the specific water to be treated, in accordance with the equipment's characteristics and current regulations.

The distributor must guarantee the correct installation and commissioning of the equipment as indicated by the manufacturer and applicable regulations, and shall also be responsible for any non-conformity resulting from incorrect application, installation, or commissioning of the equipment.

To make a warranty claim, the purchase invoice must be presented. The three-year period is counted from the date of purchase from the distributor.

If your equipment experiences any issues during the warranty period, please contact your distributor.



Aiguafreda, 8
Pol. Ind. L'Ametlla Park
08480, L'Ametlla del Vallès
Barcelona - Spain